

The Ash outdoor wall sconce is a modern take on the classic industrial-style light fixture. The Ash features a sleek metal shade and clear diffuser that creates a column of diffused light from under the shade. Ash wall sconces feature energy-efficient, fully dimmable integrated LED lighting. Available in four sizes (8", 10", 12", 16") and two finishes: Bronze and Charcoal.

## Outstanding protection against the elements:

- Powder coat finishes
- Stainless Steel mounting hardware
- Impact-resistant, UV stabilized acrylic lensing
- IP-65 Rated

## SPECIFICATIONS

DELIVERED LUMENS	515 or 1189 with clear cylinder 300 or 613 with clear lens
WATTS	8 or 18
VOLTAGE	Universal 120-277V, with integral transient 2.5kV surge protection (driver)
DIMMING	0-10, ELV
LIGHT DISTRIBUTION	Symmetric
MOUNTING OPTIONS	Wall
PERFORMANCE OPTIONS	Photocontrol / Surge Protector
CCT	2700K or 3000K
CRI	90+
COLOR BINNING	3 Step
BUG RATING	B1-U1-G0
DARK SKY	Compliant (Lensed version only)
WET LISTED	IP65
GENERAL LISTING	ETL
CALIFORNIA TITLE 24	Can be used to comply with CEC 2016 Title 24 Part 6 for outdoor use. Registration with CEC Appliance Database not required.
START TEMP	-30°C
FIELD SERVICEABLE LED	Yes
CONSTRUCTION	Aluminum
HARDWARE	Stainless Steel
FINISH	Powder Coat
LED LIFETIME	L70; 70,000 Hours
WARRANTY*	5 Years
WEIGHT	3.5 lbs.

\* Visit [techlighting.com](http://techlighting.com) for specific warranty limitations and details.

## ORDERING INFORMATION

7000WASH	CRI / CCT	LENGTH	LENS	FINISH	VOLTAGE	OPTIONS
L927	LED LO-OUTPUT 90 CRI, 2700K	8, 8"	C CLEAR CYLINDER	Z BRONZE	UNV 120V-277V UNIVERSAL	NONE
H927	LED HI-OUTPUT 90 CRI, 2700K		D CLEAR LENS	H CHARCOAL		PC BUTTON PHOTOCONTROL
L930	LED LO-OUTPUT 90 CRI, 3000K					SP SURGE PROTECTION
H930	LED HI-OUTPUT 90 CRI, 3000K					PCSP BUTTON PHOTOCONTROL & SURGE PROTECTION



ASH 8  
shown in bronze/clear lens



ASH 8  
shown in charcoal/clear cylinder

# ASH 8 WALL SCONCE

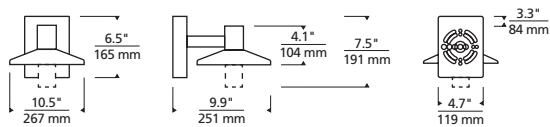

Ash 8

## PHOTOMETRICS\*

\*For latest photometrics, please visit [www.techlighting.com/OUTDOOR](http://www.techlighting.com/OUTDOOR)

### ASH 8 WITH CLEAR CYLINDER

Total Lumen Output: 1189  
Total Power: 18  
Luminaire Efficacy: 66  
Color Temp: 3000K  
CRI: 90  
BUG Rating: B1-U1-G0

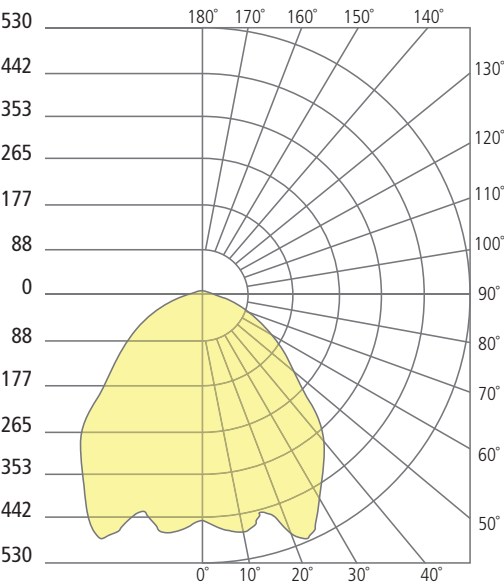

## PROJECT INFO

FIXTURE TYPE & QUANTITY	JOB NAME & INFO	NOTES



VISUAL COMFORT GROUP

## DESCRIPTION

The EPIC Collection delivers custom luminaire flexibility with high quality, yet availability expectations of standard specification grade product. The EPIC Collection can be dressed to suit any application. Recognizing evolving environmental and legislative trends, the EPIC Collection delivers world class LED optical and performance solutions to the decorative luminaire marketplace.

Catalog #		Type
Project	MINERS BASE CAMP	B
Comments		Date
Prepared by	ILLUMINATION SYSTEMS	2/24/20

## SPECIFICATION FEATURES

### Construction

**TOP:** Cast aluminum top housing attaches to cast aluminum mounting arm hub with four stainless steel fasteners. One-piece silicone gasket between mounting hub and top casting seals out moisture and contaminants. (See the mounting accessories section for a full selection of mounting arms. (Only these arms are compatible with the Epic luminaire). **MIDSECTION:** Continuous silicone gaskets seal lens to top casting and shade. The mid section features cast aluminum construction and stainless steel assembly. **SHADES:** Heavy gauge precision spun aluminum shades offer superior surface finish and consistency in form. **DOORFRAME:** Die-cast aluminum 1/8" thick door and doorframe seal to underside of shade with a thick wall continuous silicone gasket. Mounting hub ships attached to mounting arm.

### Optics

Choice of twelve patented, high-efficiency AccuLED Optic™ technology manufactured from

injection-molded acrylic. Optics are precisely designed to shape the optics, maximizing efficiency and application spacing. AccuLED Optic technology, creates consistent distributions with the scalability to meet customized application requirements. Offered Standard in 4000K (+/- 275K) CCT and nominal 70 CRI. Optional 3000K CCT and 5000K CC. For the ultimate level of spill light control, an optional house-side shield accessory can be field or factory installed. The house-side shield is designed to seamlessly integrate with the SL2, SL3 or SL4 optics.

### Electrical

LED drivers mount to die-cast aluminum back housing for optimal heat sinking, operation efficacy, and prolonged life. Standard drivers feature electronic universal voltage (120-277V 50/60Hz), 347V 60Hz or 480V 60Hz operation, greater than 0.9 power factor, less than 20% harmonic distortion, and is suitable for operation in -40°C to 40°C ambient environments. All fixtures are shipped standard

with 10kV/10kA common – and differential – mode surge protection. LightBARs feature and IP66 enclosure rating and maintain greater than 95% lumen maintenance at 60,000 hours per IESNA TM-21. Occupancy sensor and dimming options available.

### Finish

Housing is finished in five-stage super TGIC polyester powder coat paint, 2.5 mil nominal thickness for superior protection against fade and wear. LightBAR™ cover plates are standard white and may be specified to match finish of luminaire housing. Standard colors include black, bronze, grey, white, dark platinum and graphite metallic. RAL and custom color matches available. Consult Outdoor Architectural Colors brochure for a complete selection.

### Warranty

Five-year warranty.



## ECM/EMM EPIC MEDIUM LED

1 - 4 LightBARs

Solid State LED

DECORATIVE AREA LUMINAIRE

## DIMENSIONS

### ECM Classical

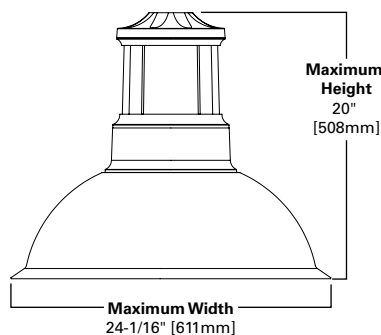

### EMM Modern

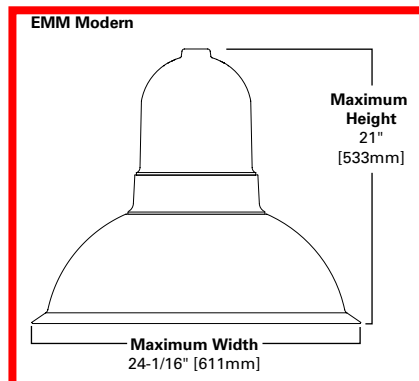

See configurations for more detailed information.

## CERTIFICATION DATA

UL/cUL Listed  
IP66 LightBARs  
LM79 / LM80 Compliant  
2G Vibration Tested  
ISO 9001

## ENERGY DATA

Electronic LED Driver  
>0.9 Power Factor  
<20% Total Harmonic Distortion  
120-277V 50/60Hz, 347V/60Hz,  
480V/60Hz  
-40°C Minimum Temperature  
40°C Ambient Temperature Rating

## EPA

Effective Projected Area: (Sq. Ft.) 0.94

## SHIPPING DATA

Approximate Net Weight:  
45 lbs. [20 kgs.]

## CONFIGURATIONS

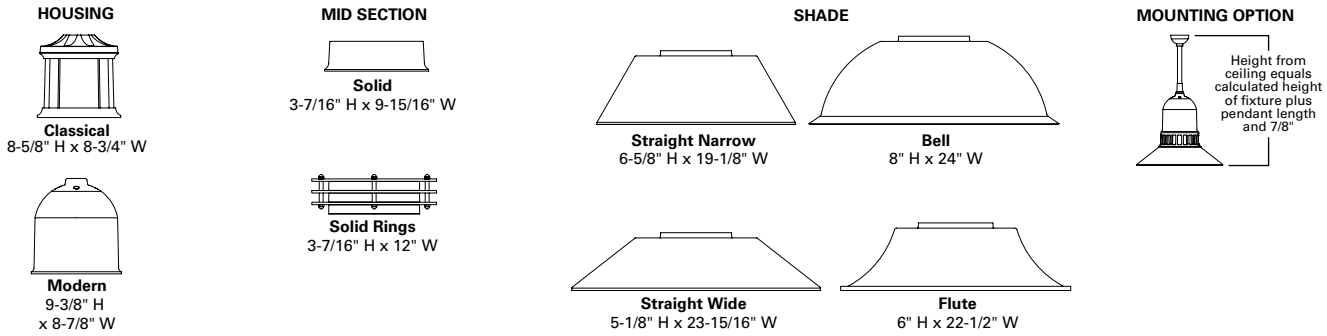

## POWER AND LUMENS BY BAR COUNT (21 LED LIGHTBARS)

Number of LightBARs		E01	E02	E03	E04
<b>Drive Current</b>		350mA Drive Current			
<b>Power (Watts)</b>		25W	52W	75W	97W
<b>Current @ 120V (A)</b>		0.22	0.44	0.63	0.82
<b>Current @ 277V (A)</b>		0.10	0.20	0.28	0.36
<b>Power (Watts)</b>		31W	58W	82W	99W
<b>Current @ 347V (A)</b>		0.11	0.19	0.28	0.29
<b>Current @ 480V (A)</b>		0.09	0.15	0.20	0.21
<b>T2</b>	Lumens	2,948	5,896	8,844	11,792
	BUG Rating	B1-U0-G1	B2-U0-G2	B3-U0-G3	B3-U0-G3
<b>T3</b>	Lumens	2,936	5,873	8,809	11,745
	BUG Rating	B1-U0-G1	B2-U0-G2	B3-U0-G3	B3-U0-G3
<b>T4</b>	Lumens	2,876	5,752	8,627	11,503
	BUG Rating	B1-U0-G1	B1-U0-G2	B1-U0-G2	B2-U0-G3
<b>5MQ</b>	Lumens	3,054	6,108	9,161	12,215
	BUG Rating	B2-U0-G1	B3-U0-G1	B3-U0-G2	B4-U0-G2
<b>5WQ</b>	Lumens	2,987	5,975	8,962	11,949
	BUG Rating	B2-U0-G1	B3-U0-G1	B3-U0-G2	B4-U0-G2
<b>5XQ</b>	Lumens	2,982	5,963	8,945	11,926
	BUG Rating	B2-U0-G1	B3-U0-G2	B3-U0-G3	B4-U0-G3
<b>SL2</b>	Lumens	2,878	5,756	8,634	11,512
	BUG Rating	B1-U0-G1	B1-U0-G2	B2-U0-G2	B2-U0-G2
<b>SL3</b>	Lumens	2,894	5,788	8,682	11,576
	BUG Rating	B1-U0-G1	B1-U0-G2	B2-U0-G2	B2-U0-G2
<b>SL4</b>	Lumens	2,823	5,647	8,470	11,294
	BUG Rating	B1-U0-G1	B1-U0-G2	B2-U0-G2	B2-U0-G2
<b>RW</b>	Lumens	2,957	5,915	8,872	11,829
	BUG Rating	B2-U0-G2	B3-U0-G3	B3-U0-G3	B3-U0-G3
<b>SLL/SLR</b>	Lumens	2,616	5,231	7,847	10,462
	BUG Rating	B1-U0-G2	B1-U0-G2	B1-U0-G3	B2-U0-G3

## POWER AND LUMENS BY BAR COUNT (7 LED LIGHTBARS)

Number of LightBARs		F01	F02	F03	F04
<b>Drive Current</b>		1A Drive Current			
<b>Power (Watts)</b>		26W	55W	78W	102W
<b>Current @ 120V (A)</b>		0.22	0.46	0.66	0.86
<b>Current @ 277V (A)</b>		0.10	0.21	0.29	0.37
<b>Power (Watts)</b>		32W	60W	85W	105W
<b>Current @ 347V (A)</b>		0.11	0.19	0.28	0.30
<b>Current @ 480V (A)</b>		0.09	0.15	0.21	0.22
<b>T2</b>	Lumens	2,434	4,867	7,301	9,735
	BUG Rating	B1-U0-G1	B2-U0-G2	B2-U0-G2	B3-U0-G3
<b>T3</b>	Lumens	2,424	4,848	7,272	9,696
	BUG Rating	B1-U0-G1	B2-U0-G2	B2-U0-G2	B3-U0-G3
<b>T4</b>	Lumens	2,374	4,748	7,122	9,496
	BUG Rating	B1-U0-G1	B1-U0-G2	B1-U0-G2	B2-U0-G2
<b>5MQ</b>	Lumens	2,521	5,042	7,563	10,084
	BUG Rating	B2-U0-G1	B3-U0-G1	B3-U0-G1	B3-U0-G2
<b>5WQ</b>	Lumens	2,466	4,932	7,398	9,864
	BUG Rating	B2-U0-G1	B3-U0-G1	B3-U0-G2	B4-U0-G2
<b>5XQ</b>	Lumens	2,461	4,923	7,384	9,845
	BUG Rating	B2-U0-G1	B3-U0-G2	B3-U0-G2	B4-U0-G3
<b>SL2</b>	Lumens	2,376	4,752	7,127	9,503
	BUG Rating	B1-U0-G1	B1-U0-G1	B2-U0-G2	B2-U0-G2
<b>SL3</b>	Lumens	2,389	4,778	7,167	9,556
	BUG Rating	B1-U0-G1	B1-U0-G1	B1-U0-G2	B2-U0-G2
<b>SL4</b>	Lumens	2,331	4,662	6,993	9,323
	BUG Rating	B1-U0-G1	B1-U0-G2	B1-U0-G2	B2-U0-G2
<b>RW</b>	Lumens	2,441	4,883	7,324	9,765
	BUG Rating	B1-U0-G1	B2-U0-G2	B3-U0-G3	B3-U0-G3
<b>SLL/SLR</b>	Lumens	2,159	4,318	6,478	8,637
	BUG Rating	B1-U0-G1	B1-U0-G2	B1-U0-G3	B1-U0-G3

## LUMEN MAINTENANCE

Ambient Temperature	25,000 Hours*	50,000 Hours*	60,000 Hours*	100,000 Hours	Theoretical L70 (Hours)
25°C	> 99%	> 97%	> 96%	> 93%	> 450,000
40°C	> 98%	> 97%	> 96%	> 92%	> 425,000
50°C	> 97%	> 96%	> 95%	> 91%	> 400,000

\* Per IESNA TM-21 data.

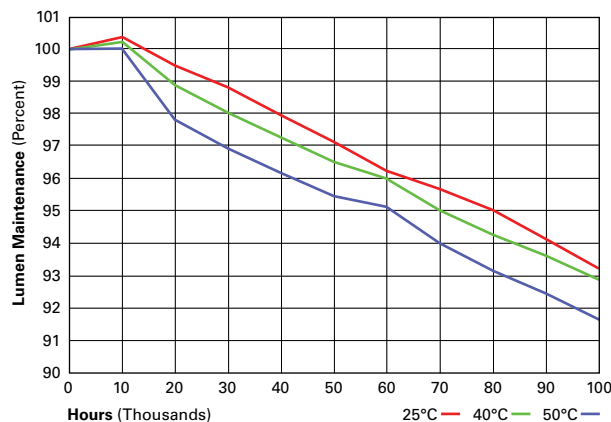

## LUMEN MULTIPLIER

Ambient Temperature	Lumen Multiplier
10°C	1.02
15°C	1.01
25°C	1.00
40°C	0.99
50°C	0.96

CONTROL OPTIONS

0-10V (DIM)

This fixture is offered standard with 0-10V dimming driver(s). The DIM option provides 0-10V dimming wire leads for use with a lighting control panel or other control method.

Photocontrol (PC, PER and PER7)

Optional button-type photocontrol (PC) and photocontrol receptacles (PER and PER7) provide a flexible solution to enable “dusk-to-dawn” lighting by sensing light levels. Advanced control systems compatible with NEMA 7-pin standards can be utilized with the PER7 receptacle.

Dimming Occupancy Sensor (MS/DIM-LXX, MS/X-LXX and MS-LXX)

These sensors are factory installed in the luminaire housing. When the MS/DIM-LXX sensor option is selected, the occupancy sensor is connected to a dimming driver and the entire luminaire dims when there is no activity detected. When activity is detected, the luminaire returns to full light output. The MS/DIM sensor is factory preset to dim down to approximately 50 percent power with a time delay of five minutes. The MS-LXX sensor is factory preset to turn the luminaire off after five minutes of no activity. The MS/X-LXX is also preset for five minutes and only controls the specified number of light engines to maintain steady output from the remaining light engines.

These occupancy sensors includes an integral photocell that can be activated with the FSIR-100 accessory for “dusk-to-dawn” control or daylight harvesting - the factory preset is OFF. The FSIR-100 is a wireless tool utilized for changing the dimming level, time delay, sensitivity and other parameters.

A variety of sensor lens are available to optimize the coverage pattern for mounting heights from 8'-40'.

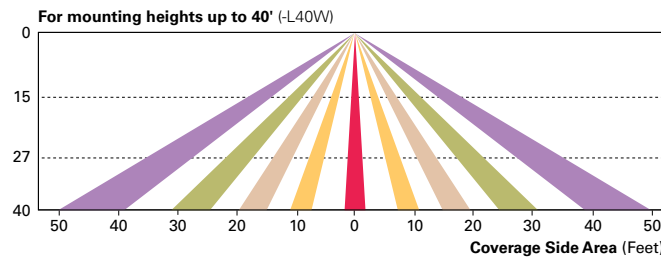
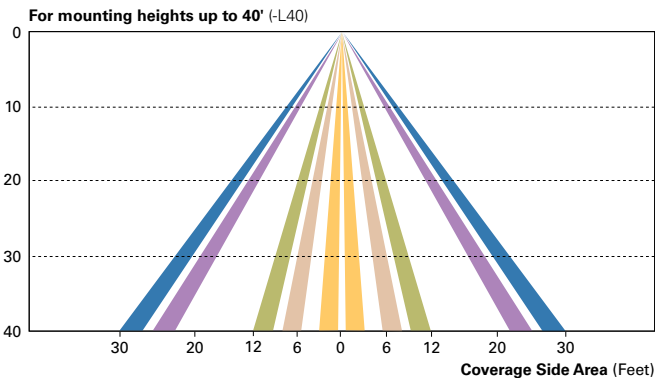
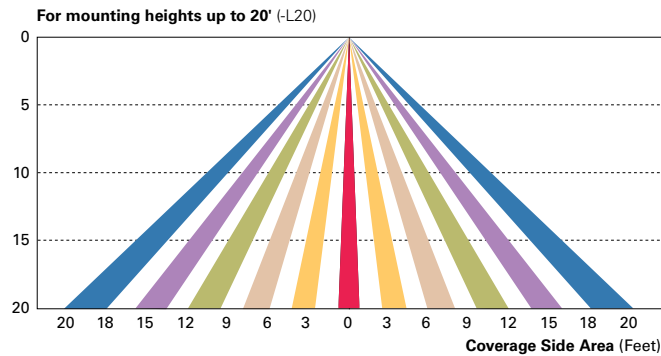
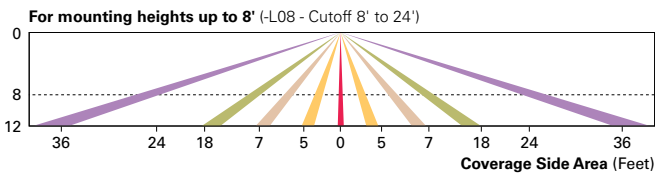

## ORDERING INFORMATION

Sample Number: ECM-E04-LED-E1-T2-FL-GM

Product Family <sup>1</sup>	Number of LightBARs <sup>2, 3</sup>	Lamp Type	Voltage	Distribution	Mid Section Type	Shade Type	Color <sup>5</sup>
ECM=Epic Classical Medium EMM=Epic Modern Medium	E01=(1) 21 LED LightBAR E02=(2) 21 LED LightBARs E03=(3) 21 LED LightBARs E04=(4) 21 LED LightBARs F01=(1) 7 LED LightBAR F02=(2) 7 LED LightBARs F03=(3) 7 LED LightBARs F04=(4) 7 LED LightBARs	LED=Solid State Light Emitting Diodes	E1=Electronic (120-277V) 347=347V 480=480V <sup>4</sup>	T2=Type II T3=Type III T4=Type IV SL2=Type II w/Spill Control SL3=Type III w/Spill Control SL4=Type IV w/Spill Control 5MQ=Type V Square Medium 5WQ=Type V Square Wide 5XQ=Type V Square Extra Wide RW=Rectangular Wide SLL=90° Spill Light Eliminator Left SLR=90° Spill Light Eliminator Right	SO=Solid SR=Solid Rings	SN=Straight Narrow SW=Straight Wide BL=Bell FL=Flute	AP=Grey BZ=Bronze BK=Black DP=Dark Platinum GM=Graphite Metallic WH=White
Options (Add as Suffix)		Accessories (Order Separately) <sup>13</sup>					
2L=Two Circuits <sup>6</sup> 7030=70 CRI / 3000K CCT <sup>7</sup> 7050=70 CRI / 5000K CCT <sup>7</sup> 8030=80 CRI / 3000K CCT <sup>7</sup> LCF=LightBAR Cover Plate Matches Housing Finish MS-LXX=Motion Sensor for ON/OFF Operation <sup>8</sup> MS/X-LXX=Motion Sensor for Bi-Level Switching <sup>9</sup> PMXX=Pendant Mount (XX=Pendant Length in Inches, 9.5" min - 48.0" max) <sup>10</sup> HSS=Factory Installed House Side Shield <sup>11</sup> DIM=0-10V Dimming Driver <sup>12</sup>		OA/RA1016=NEMA Twistlock Photocontrol - Multi-Tap OA/RA1027=NEMA Twistlock Photocontrol - 480V OA/RA1201=NEMA Twistlock Photocontrol - 347V OA/RA1013=Photocontrol Shorting Cap LB/HSS-21=Field Installed House Side Shield for "E" LightBARs <sup>11, 15</sup> LB/HSS-07=Field Installed House Side Shield for "F" LightBARs <sup>11, 15</sup>  Mounting Accessories (Order Separately) Classical VA6150-XX=Bishop Wall Mount Arm VA6151-XX=Bishop Wall Mount Arm with Cross Rod VA6152-XX=Traditional Wall Mount Arm VA6153-XX=Traditional Wall Mount Arm with 45° Strap VA6154-XX=Bishop Single Pole Mount Arm VA6155-XX=Bishop Single Pole Mount Arm with Cross Rod VA6156-XX=Bishop Twin Pole Mount Arm VA6157-XX=Bishop Twin Pole Mount Arm with Cross Rods VA6158-XX=Traditional Single Pole Mount Arm VA6159-XX=Traditional Single Pole Mount Arm with Rounded Upper Bar VA6160-XX=Traditional Single Pole Mount Arm with Rounded Lower Bar <sup>14</sup> VA6161-XX=Traditional Single Pole Mount Arm with 45° Upper Bar VA6162-XX=Traditional Single Pole Mount Arm with 45° Lower Bar <sup>14</sup> VA6163-XX=Traditional Single Pole Mount Arm with 45° Upper Strap VA6165-XX=Traditional Twin Pole Mount Arm VA6166-XX=Traditional Twin Pole Mount Arm with Rounded Upper Bars VA6167-XX=Traditional Twin Pole Mount Arm with Rounded Lower Bars <sup>14</sup> VA6168-XX=Traditional Twin Pole Mount Arm with 45° Upper Bars VA6169-XX=Traditional Twin Pole Mount Arm with 45° Lower Bars <sup>14</sup> VA6170-XX=Traditional Twin Pole Mount Arm with 45° Upper Straps VA6171-XX=Mast Arm Adapter Modern VA6101-XX=Bishop Wall Mount Arm VA6102-XX=Bishop Wall Mount Arm with Cross Rod VA6103-XX=Traditional Wall Mount Arm VA6104-XX=Traditional Wall Mount Arm with 45° Strap VA6105-XX=Bishop Single Pole Mount Arm VA6106-XX=Bishop Single Pole Mount Arm with Cross Rod VA6107-XX=Bishop Twin Pole Mount Arm VA6108-XX=Bishop Twin Pole Mount Arm with Cross Rods VA6109-XX=Traditional Single Pole Mount Arm VA6110-XX=Traditional Single Pole Mount Arm with Rounded Upper Bar VA6111-XX=Traditional Single Pole Mount Arm with Rounded Lower Bar <sup>14</sup> VA6112-XX=Traditional Single Pole Mount Arm with 45° Upper Bar VA6113-XX=Traditional Single Pole Mount Arm with 45° Lower Bar <sup>14</sup> VA6114-XX=Traditional Single Pole Mount Arm with 45° Upper Strap VA6116-XX=Traditional Twin Pole Mount Arm VA6117-XX=Traditional Twin Pole Mount Arm with Rounded Upper Bars VA6118-XX=Traditional Twin Pole Mount Arm with Rounded Lower Bars <sup>14</sup> VA6119-XX=Traditional Twin Pole Mount Arm with 45° Upper Bars VA6120-XX=Traditional Twin Pole Mount Arm with 45° Lower Bars <sup>14</sup> VA6121-XX=Traditional Twin Pole Mount Arm with 45° Upper Straps VA6122-XX=Mast Arm Adapter				Accessory Options <sup>16</sup> V=Victorian Finial <sup>17</sup> M=Modern Finial <sup>17</sup> A=Architectural Finial <sup>17</sup> N=Nostalgic Finial <sup>17</sup> R=NEMA Twistlock Photocontrol Receptacle <sup>18</sup>	

## NOTES:

- Arm not included. Order separately. See accessories.
- Standard 4000K CCT and greater than 70 RL.
- 21 LED LightBAR powered by 350mA and 7 LED LightBAR powered by 1A.
- Only for use with 480V Wye systems. Per NEC, not for use with ungrounded systems, impedance grounded systems or corner grounded systems (commonly known as Three Phase Three Wire Delta, Three Phase High Leg Delta and Three Phase Corner Grounded Delta systems).
- Custom and RAL color matching available upon request. Consult your lighting representative at Eaton for more information.
- Low-level output varies by bar count. Consult factory. Requires quantity of two or more LightBARs.
- Consult customer service for lead times and multiplier.
- Sensor mounted to the luminaire. Available in E01-E04 and F01-F04 configurations. Replace "XX" with mounting height in feet for proper lens selection, (e.g., MS-L25). Consult factory for additional information.
- Sensor mounted to the luminaire. Available in E02-E04 and F02-F04 configurations. Replace "X" with number of LightBARs operating in low output mode and replace XX with mounting height in feet for proper lens selection, (e.g., MS/3-L25). Maximum four bars in low output mode. Consult factory for additional information.
- Pendant mount option "PMXX" must be used with Invue Pendant mount kit only. Includes pendant pipe, swivel hangar and canopy cover. Other pendant lengths can be specified in inches (XX). Minimum pendant length is 9-1/2". For lengths above 48", consult your lighting representative at Eaton for more information.
- Only for use with SL2, SL3 and SL4 distributions.
- Dimming leads provide for external 0-10V control system (by others).
- Replace XX with color suffix.
- Only available with traditional arms.
- One required for each LightBAR.
- Add as suffix to mounting accessory. Example: VA6106-BK-R.
- Not available with finials, pendant mount "PM48" or bishop wall mounts.
- Requires use of 4" O.D. round straight pole.

## MOUNTING ACCESSORIES

Pole mount arms are designed to fit both medium ECM/EMM housings. (Only these arms are compatible with the Epic luminaire). Arms feature a precision welded cast aluminum mounting hub for attachment of fixture head to arm with four stainless steel fasteners. Wall mount arms compliment pole mount luminaires and attractively transition fixture scale in lower mounting height pedestrian environments. Wall mount arms are designed to fit both medium ECM/EMM housings. Arms feature a precision welded cast aluminum mounting hub for attachment of fixture head to arm with four stainless steel fasteners.

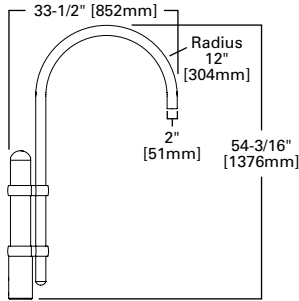
**BISHOP SINGLE POLE MOUNT ARM**

VA6105 (Modern), VA6154 (Classical)  
Slipfits over 4" round straight pole, or 4" O.D. by 6" tall round tenon.  
Weight: 24 lbs. E.P.A: 0.92

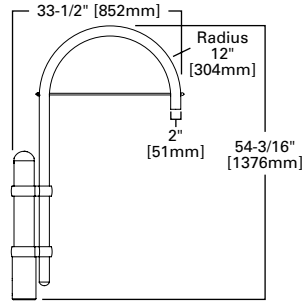
**BISHOP SINGLE POLE MOUNT ARM WITH CROSS ROD**

VA6106 (Modern), VA6155 (Classical)  
Slipfits over 4" round straight pole, or 4" O.D. by 6" tall round tenon.  
Weight: 25 lbs. E.P.A: 0.98

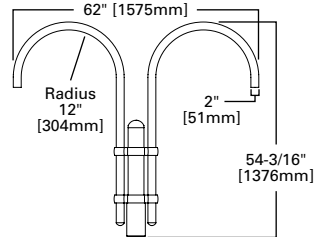
**BISHOP TWIN POLE MOUNT ARM**

VA6107 (Modern), VA6156 (Classical)  
Slipfits over 4" round straight pole, or 4" O.D. by 6" tall round tenon.  
Weight: 37 lbs. E.P.A: 1.43

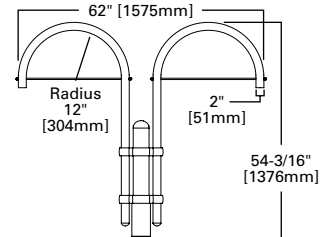
**BISHOP TWIN POLE MOUNT ARM WITH CROSS RODS**

VA6108 (Modern), VA6157 (Classical)  
Slipfits over 4" round straight pole, or 4" O.D. by 6" tall round tenon.  
Weight: 39 lbs. E.P.A: 1.55

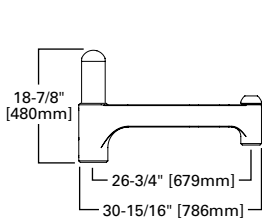
**TRADITIONAL SINGLE POLE MOUNT ARM**

VA6109 (Modern), VA6158 (Classical)  
Slipfits over 4" round straight pole, or 4" O.D. by 6" tall round tenon.  
Weight: 20 lbs. E.P.A: 0.86

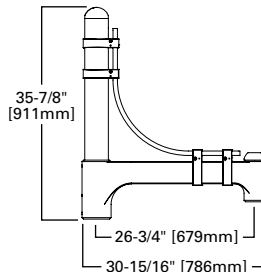
**TRADITIONAL SINGLE POLE MOUNT ARM WITH ROUNDED UPPER BAR**

VA6110 (Modern), VA6159 (Classical)  
Slipfits over 4" round straight pole, or 4" O.D. by 6" tall round tenon.  
Weight: 28 lbs. E.P.A: 1.4

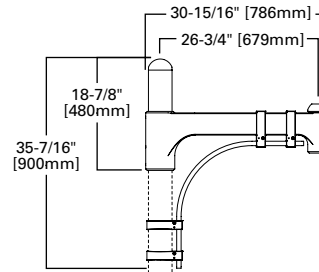
**TRADITIONAL SINGLE POLE MOUNT ARM WITH ROUNDED LOWER BAR**

VA6111 (Modern), VA6160 (Classical)  
Slipfits over 4" round straight pole, or 4" O.D. by 6" tall round tenon.  
Weight: 25 lbs. E.P.A: 1.16

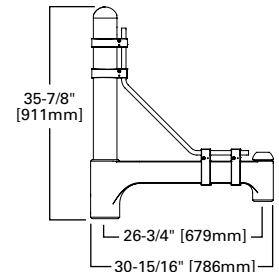
**TRADITIONAL SINGLE POLE MOUNT ARM WITH 45° UPPER BAR**

VA6112 (Modern), VA6161 (Classical)  
Slipfits over 4" round straight pole, or 4" O.D. by 6" tall round tenon.  
Weight: 28 lbs. E.P.A: 1.38

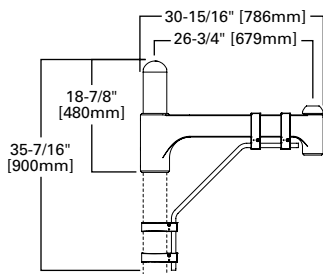
**TRADITIONAL SINGLE POLE MOUNT ARM WITH 45° LOWER BAR**

VA6113 (Modern), VA6162 (Classical)  
Slipfits over 4" round straight pole, or 4" O.D. by 6" tall round tenon.  
Weight: 24 lbs. E.P.A: 1.17

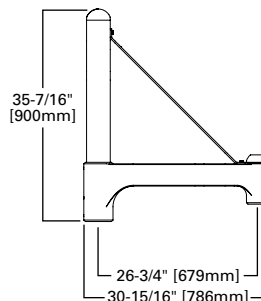
**TRADITIONAL SINGLE POLE MOUNT ARM WITH 45° UPPER STRAP**

VA6114 (Modern), VA6163 (Classical)  
Slipfits over 4" round straight pole, or 4" O.D. by 6" tall round tenon.  
Weight: 24 lbs. E.P.A: 1.17

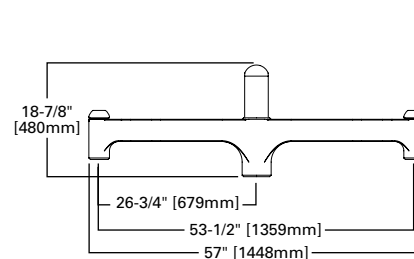
**TRADITIONAL TWIN POLE MOUNT ARM**

VA6116 (Modern), VA6165 (Classical)  
Slipfits over 4" round straight pole, or 4" O.D. by 6" tall round tenon.  
Weight: 30 lbs. E.P.A: 1.44

## MOUNTING ACCESSORIES

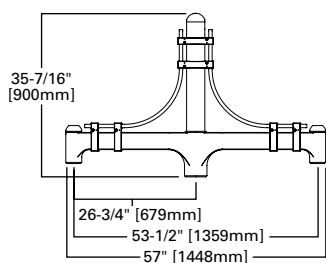
**TRADITIONAL TWIN POLE  
MOUNT ARM WITH ROUNDED  
UPPER BARS**

VA6117 (Modern), VA6166 (Classical)  
Slipfits over 4" round straight pole,  
or 4" O.D. by 6" tall round tenon.  
Weight: 43 lbs. E.P.A: 2.28

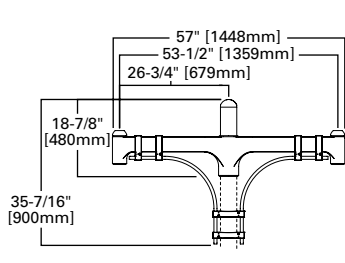
**TRADITIONAL TWIN POLE  
MOUNT ARM WITH ROUNDED  
LOWER BARS**

VA6118 (Modern), VA6167 (Classical)  
Slipfits over 4" round straight pole,  
or 4" O.D. by 6" tall round tenon.  
Weight: 40 lbs. E.P.A: 2.04

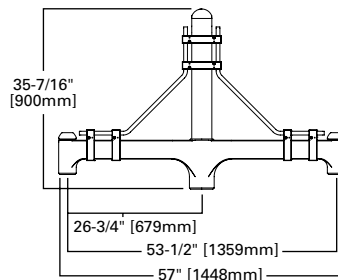
**TRADITIONAL TWIN POLE  
MOUNT ARM WITH 45° UPPER BARS**

VA6119 (Modern), VA6168 (Classical)  
Slipfits over 4" round straight pole,  
or 4" O.D. by 6" tall round tenon.  
Weight: 43 lbs. E.P.A: 2.24

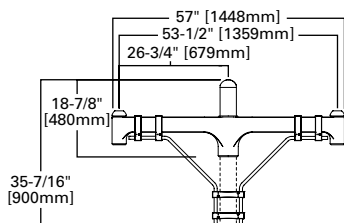
**TRADITIONAL TWIN POLE  
MOUNT ARM WITH 45° LOWER BARS**

VA6120 (Modern), VA6169 (Classical)  
Slipfits over 4" round straight pole,  
or 4" O.D. by 6" tall round tenon.  
Weight: 40 lbs. E.P.A: 2.0

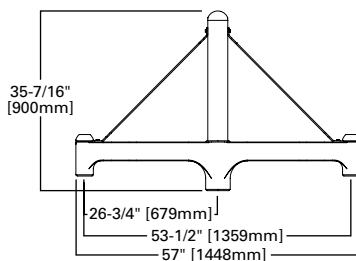
**TRADITIONAL TWIN POLE  
MOUNT ARM WITH 45° UPPER STRAPS**

VA6121 (Modern), VA6170 (Classical)  
Slipfits over 4" round straight pole,  
or 4" O.D. by 6" tall round tenon.  
Weight: 37 lbs. E.P.A: 1.81

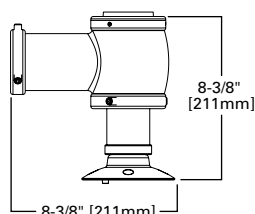

**MAST ARM ADAPTER**

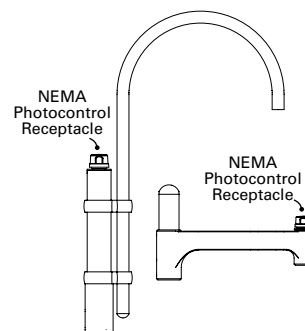
VA6122 (Modern), VA6171 (Classical)  
Secures fixture to nominal 2" pipe  
(2-3/8" horizontal O.D.)  
Weight: 4 lbs.

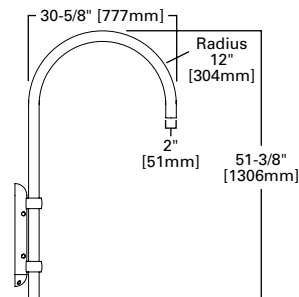

**NEMA TWISTLOCK PHOTOCONTROL (R)**

Order separately (Not compatible with  
finials or wall mount bishop arms)

## Wall Mount Accessories

**BISHOP WALL MOUNT ARM**

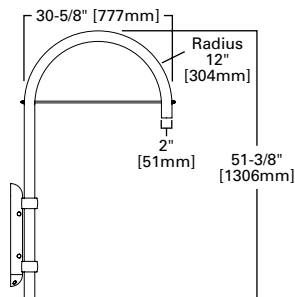
VA6101 (Modern), VA6150 (Classical)  
Mounts to wall with four stainless  
steel lag bolts (provided by other).  
Weight: 16 lbs.

**BISHOP WALL MOUNT ARM  
WITH CROSS ROD**

VA6102 (Modern), VA6151 (Classical)  
Mounts to wall with four stainless  
steel lag bolts (provided by other).  
Weight: 17 lbs.

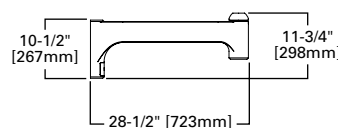
**TRADITIONAL WALL MOUNT ARM**

VA6103 (Modern), VA6152 (Classical)  
Mounts to wall with four stainless  
steel lag bolts (provided by other).  
Weight: 17 lbs.

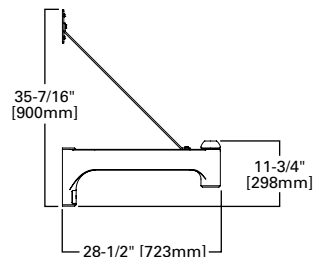
**TRADITIONAL WALL MOUNT ARM  
WITH 45° STRAP**

VA6104 (Modern), VA6153 (Classical)  
Mounts to wall with four stainless  
steel lag bolts (provided by other).  
Weight: 18 lbs.